

8G31DT

SPECIFICATIONS

Nominal Voltage (V)	12V
Capacity at C/100	108 Ah
Capacity at C/20	97.6 Ah
Capacity at C/5	80.5 Ah
Weight	68.5 lbs. (31 kg)
Plate Alloy	Lead Calcium
Posts	Forged Terminals & Bushings
Container/Cover	Polypropylene
Operating Temperature Range	-76°F (-60°C) - 140°F (60°C)
Charge Voltage @ 77°F (25°C)	
Cycle Float	13.8 - 14.6 volts 13.4 - 13.6 volts
Vent	Self-sealing
Electrolyte	Sulfuric acid thixotropic gel
Terminal	S/X (SAE/STUD)

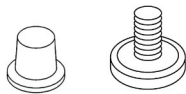

Rated non-spillable by ICAO, IATA and DOT

Made in the U.S.A. by East Penn Manufacturing Co, Inc.

Distributed by:

Valve-Regulated, Gelled-Electrolyte Battery



DIMENSIONS

Length (mm)	12.93 (328 mm)
Width (mm)	6.74 (171 mm)
Height (mm)	9.40 (239 mm) Including terminal

Gel Cycle Life vs Depth of Discharge at +25°C (77°F)
Based on BCI 2-hour Capacity

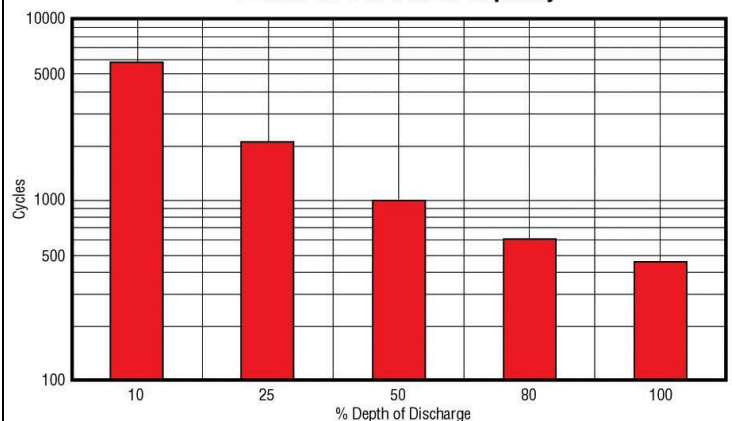

Cycle Chart applies to all MK Gel batteries (except 8GGC2 cycle chart x 2 and 8G31DT cycle chart x .67).

MK Battery

1631 South Sinclair Street • Anaheim, California 92806

Toll Free: 800-372-9253 • Fax: 714-937-0818 • E-mail: sales@mkbattery.com

